

Tree Removal/Pruning Request

Please allow up to 21 calendar days for City response to this request. Trees removed illegally may result in the City pursuing monetary penalties and/or restoration under KMC 19.36 or KZC 95.55. For more information please contact the Planning Department at (425) 587-3225; or FAX form to (425)-587-3232; or mail/come in to office: City of Kirkland, Planning Dept., 123 5th Avenue, Kirkland WA 98033.



Property Address _____

Date _____ Permit #TRE _____

For City Use

#1: Draw Site Plan Here

- Please show all trees
- Number each tree to be removed/pruned
- Show buildings and roads

Example site plan

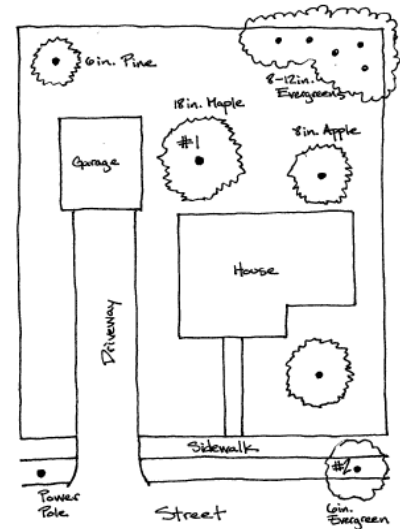

#2: List the trees (private and/or public) proposed to be removed and/or pruned:

Use additional forms if requesting to remove more trees than space provides.

For city use

Tree # from site plan	Type/Species	Size (dia)*	Location	Reason for removal/pruning	Public tree?	Public Inv #
<i>(example) #1</i>	<i>Big-leaf maple</i>	<i>18"</i>	<i>East of garage behind house</i>	<i>Remove - rotten in the middle</i>	<i>no</i>	

* Measure or estimate the diameter of the tree trunk at 4½ feet above the ground. Note if there is more than one trunk per tree

Next page, please



